



Florida Department of Transportation

RON DESANTIS
GOVERNOR

605 Suwannee Street
Tallahassee, FL 32399-0450

KEVIN J. THIBAUT, P.E.
SECRETARY

For Immediate Release
May 3, 2019

Contact: Hampton Ray
(386) 269-3607
Hampton.Ray@dot.state.fl.us

Travel Advisory: State Road 200 Lane Closure Schedule

Yulee, Fla. – This advisory is to inform community leaders and interested parties about upcoming, scheduled lane closures, traffic shifts and other construction activity on State Road 200/A1A.

The Florida Department of Transportation (FDOT) has permitted multiple lane closures as part of the State Road 200/A1A (S.R. 200) improvement projects. Below are several planned lane closures, weather permitting, from May 4 through May 10, certain activities may require unexpected lane closures for the safety of both drivers and construction workers.

Daytime lane closures:

- Northbound Interstate 95 single lane closures are expected near exit 373 from 9 a.m. to 2 p.m. on Monday, May 6. This work is necessary for crews to cut portions of shoulder to prepare for pipe installation.

Nighttime lane closures:

- Northbound Interstate 95 lane closures are expected near exit 373 nightly, May 5 through May 9 from 7 p.m. to 5:30 a.m. and again May 12 through 16 from 7 p.m. to 5:30 a.m. This work is associated with pipe installation. Note: this work may require a multi-lane closure on Interstate 95.

Future impacts:

- A traffic shift on Chester Road at S.R. 200 is expected on Saturday, May 11. Southbound Chester Road traffic will be shifted to the inside of the roadway, so crews can work on the east, outside shoulder of Chester Road behind barrier wall (map enclosed). The shift will reduce the traffic que for motorists turning on S.R. 200 or continuing straight on to Amelia Concourse. The traffic shift is necessary for the safety of construction crews and the public. It is expected to be in place for several months.

Throughout construction, drivers are encouraged to plan ahead, use caution and follow the speed limit. Construction is a temporary inconvenience toward a more permanent transportation solution.

For additional information about this project, contact Hampton Ray at:
Hampton.Ray@dot.state.fl.us or call: 904-831-FDOT (3368).

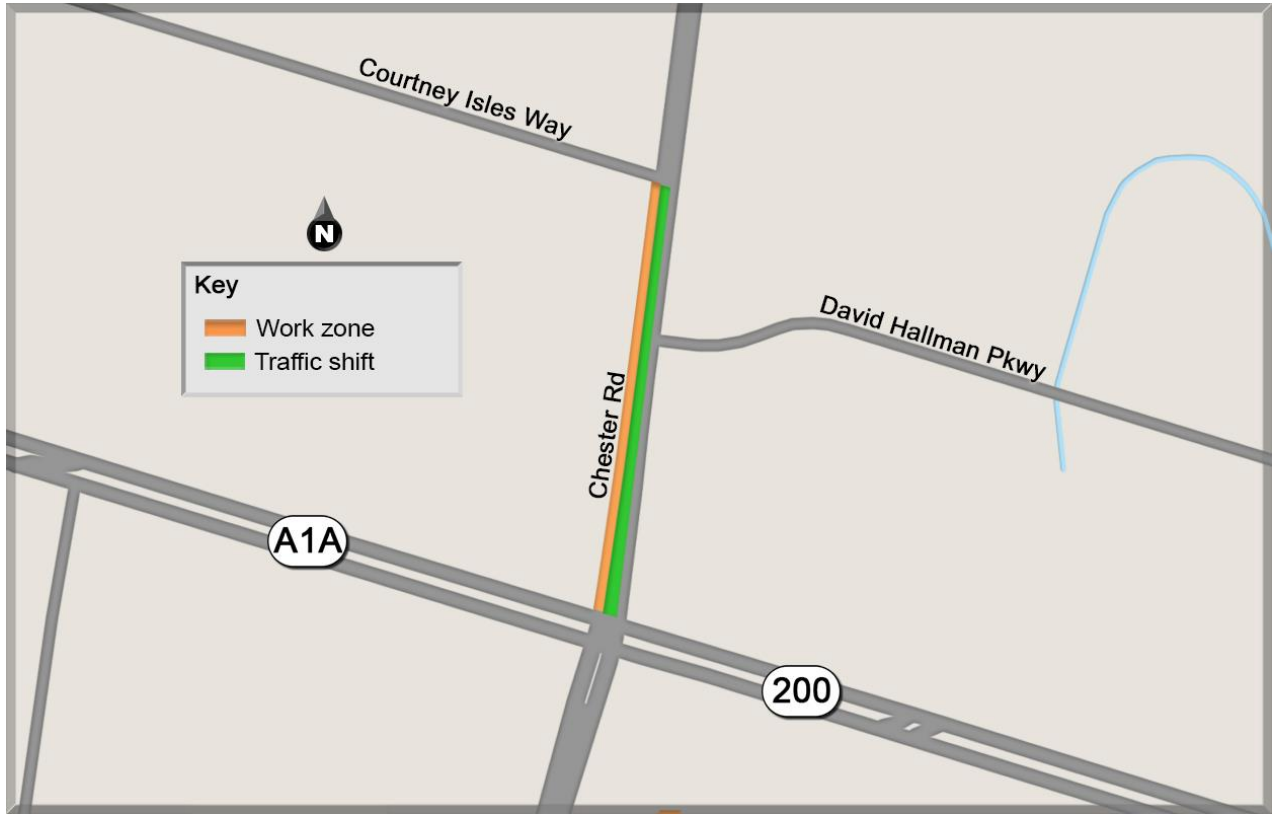

A traffic shift on Chester Road at S.R. 200 is expected to take place on Saturday, May 11, weather and schedule permitting.

###

Florida Department of Transportation